

# Tentative Specifications

## Chip-On-Tip

Concept for wireless  
Camera System

**SV-2000**



*Proposed Design Concept*

Applications for industrial borescope and various clinical solutions

### Sensor Compatibility

Image Sensor	OV6946, OV6948, OCHTA, OCHFA, OCHSA
Sensor formats	1/18" - 1mm x 1mm 400x400, .720x720 30fps 1/31" - 65mm x .65mm 200,x200, 400x400 30fps 1/14" 1.6mm x 2.6mm 800x800 MIPI up to 90fps
Frame Rate	30 – up to 90 fps
Operating Temp.	10-40 degree C
Operating Hum.	30-90%
Battery Time	4500mAh – up to 3.5hrs
Dimension	T.B.A
Weight	T.B.A.

### Performance

Wireless	Frequency - primary	5GHz, IEEE 802.11ac
	Compression	H.264
	Compatibility	iOS and Android
	Latency	~ 120ms
	Range	Up to 10m
Display	Tablet or mobile device	iOS, Android
	Capture & Playback	Via target device
Scope	SV2000	SV2H01, SV2H02, SV2H03 and future configurations

### Functions

Dual band WiFi
LED Brightness Control
Full COT camera control
Video Recording and playback – via target device
Charging USB-C
Scope is detachable from wireless module

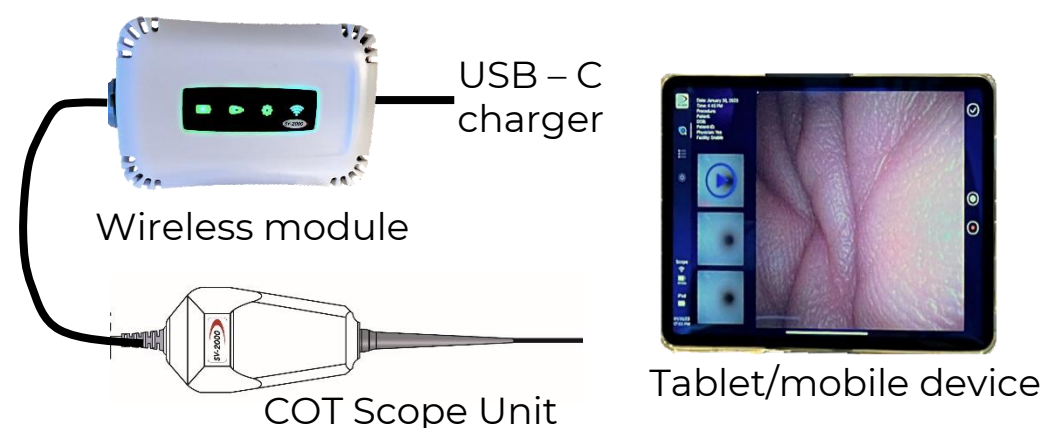

Distributed by CANON MEDICAL COMPONENTS U.S.A., INC.  
Video Sensing Devices  
2355 Main Street, Suite 150  
Irvine, California 92614

#### NOTE

- Design concept only, not an FDA approved device
- Rating, performance and functions are subject to change without notice.
- Exterior enclosure design is for reference only